

LPE

ENHANCED MULTIPLEX TRANSMISSION Full-2WAY Remote Lighting Control System

APPLICATIONS

- Manufacturing Facilities
- Office Buildings
- Retail Shopping Facilities
- Schools

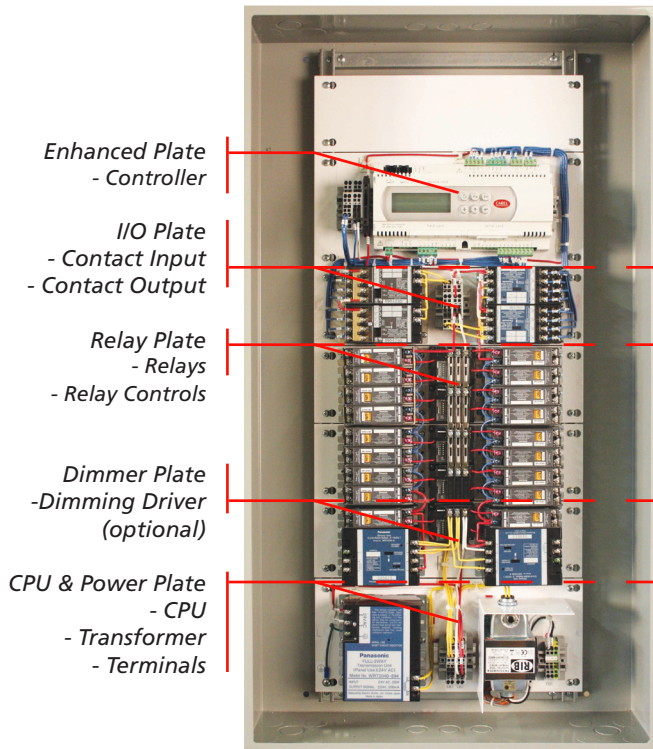

PROJECT	
LOCATION	

FEATURES

- 8 LPE programmed zones can be assigned to the Full-2Way network
- ON/OFF control of lighting and other electrical loads using mechanically latching relays
- Controls Individual, Dimmer, Group, and Pattern functions
- EEPROM memory storage of Groups and Patterns eliminate need for battery backup
- Automatic Daylight Savings Time function
- IR Address setting unit for switches and relays
- IR Programming unit sets Patterns and Groups
- Time clock configurable as 7 day with two ON/OFF events per day; 7 day with optional timed override and sweep sequence
- Accumulated run time logging
- Input photo sensor time delay prevents intermittent or false switching
- Programmable hold-on timer prevents high intensity discharge lighting from short-cycling
- System can use one Networked Daylight Sensor per zone or up to 3 PLC Sensors line of Indoor, Outdoor, Atrium and Skylight sensors
- Dimmer has programmable level and fade time settings
- Compliant with California Title 24
- 2 year warranty

DESCRIPTION

The LPE Series is the "Enhanced" version of PLC's multiplex transmission Full-2Way remote lighting control system. It uses just two 24V signal wires for all of the switches on a network, and controls lighting using mechanically latching relays. This reduces the number of wires needed compared to conventional control wiring.

The system is cost-effective and easily-configurable with programming and accessories. Centralized monitoring and control of lighting can handle up to 256 circuits per system, and it is logically capable of turning up to 127 groups of lights on and off in an entire section of any application area. Up to 72 control patterns can be programmed to match work schedules or habits, allowing for maximum occupant satisfaction while achieving energy and operating cost savings.

The LPE is easily configurable to match a daily schedule for lights to be automatically turned on and off. Passive infrared motion sensor control is also offered to turn on and off lighting depending on occupancy of a monitored building space. For additional energy savings, indoor daylight sensors are available which respond to the brightness of the environment.

In addition to the capabilities above, this system offers added energy saving possibilities by adding optional components such as dimmer controls and PLC Sensors line of CES sensors for indoor, outdoor, atrium and skylight applications. Finally, the LPE series offers a variety of user-selectable programmed operational functions such as photo control, sweep and time scheduling.

TECHNICAL DATA - LPE Series

Input Voltage: 120VAC, 277VAC or 480VAC
Output Zones: 20A Relay is mechanically latching; Rated up to 277VAC at 20A.
 (8 - 256 points)
Relays Electrical Inputs: Low Voltage: ± 24 VDC reversible polarity (± 24 VAC half-wave), Class II
 Current: 350mA
Relay Electrical Outputs: Line Voltage:
 • 20A 300VAC (General Use)
 • 2400W 120VAC (Tungsten)
 • 20A 300VAC (ballast)
 • 14,000A short circuit interrupting current
CPU Signal Voltage: ± 24 V
Signal Methods: Cyclic time sharing multiplex transmission with cut-in signal method
Signal Wires: Two wires with no polarity
Signal Transmission Distance: 1,600ft max. with 18AWG wire
Extension of Transmission Distance: Max. 9,800ft, Total of 29,500ft (with use of 5 amplifiers)
Power Failure Backup: Flash Memory for Groups/Patterns
Approvals: Compliant with California Title 24

Enhanced Processor: 8 input and output zones on Full-2Way network
Time Switch: Automatic Daylight Savings Time Function
Control Modes: 13 combinations of Photo Control, Time Switch, Sweep and Switch
Photo Control Function: SETUP: Photo set point control
 AUTO: Photo sensor control with timers (ON at low, OFF at high set points)
Input Delay: Photo sensor: Programmable with 60 sec. and setup mode override defaults
Hold-ON-Timer: Photo sensor: Programmable with 30 mins. and setup mode override defaults
Photo Sensors: Indoor, Outdoor, Atrium and Skylight Sensors (Input to Controller)

Contact Input: Inputs (each input independently configurable)
Contact Output: Line Voltage:
 • 6A 300VAC (General Use)
 • 6A 120VAC (Tungsten)
 • 6A 300VAC (ballast)
Dimmer Signal Voltage: 0-10VDC
Dimmer Signal Current: Max. 100mA to Dimming Ballast
Address Setting: Infrared Wireless or Dip Switch

Enclosure Dimensions: NEMA 1 Surface Mount Enclosure
 24"H x 20"W x 6"D
 36"H x 20"W x 6"D
 48"H x 20"W x 6"D

Temperature Range: 32° to 140°F (0° to 40°C)

Input Option Devices: Panasonic Daylight Sensors, Motion Detectors, Switches and Touchscreen display

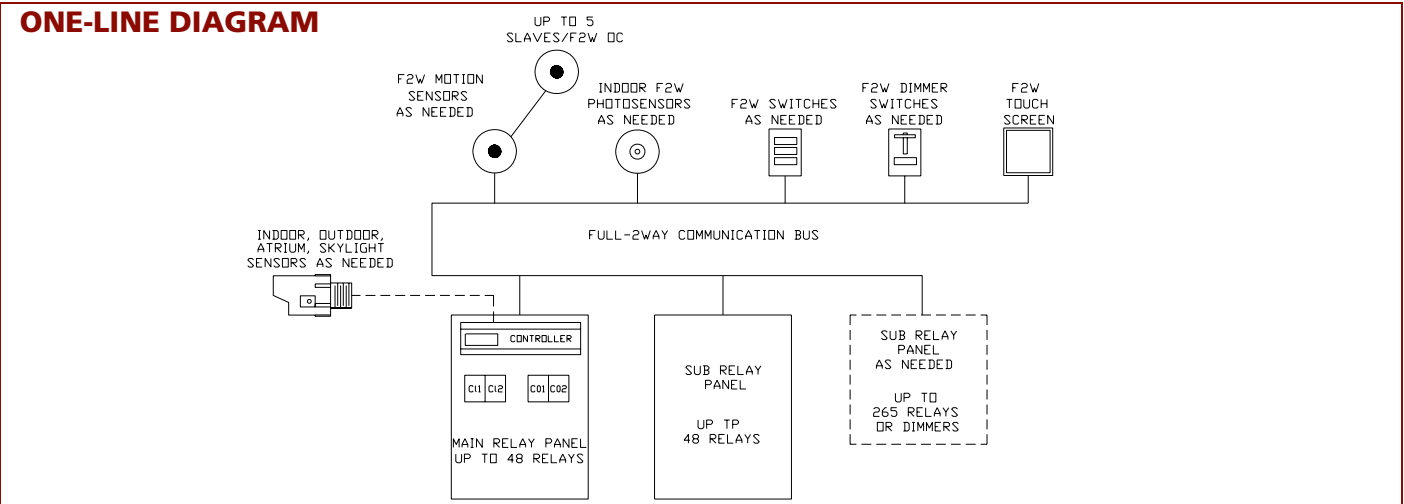

ORDERING INFORMATION

LPE - R1 OR R2 - DI - DF - V
Switching Circuits **Dimming Circuits** **Voltage**
 (Incandescent) (Fluorescent)

ACCESSORIES See LP-Series Accessories Sheet (Listed Separately)

If you have any questions, please call us toll-free at 1-866-998-5483
 3101 111th Street SW • Suite F • Everett, WA 98204
 425-353-7552 • Fax: 425-353-3353 • www.plcbuildings.com

301 LPE Rev1

A Division of PLC Multipoint, Inc.

